

CORNER DETAIL

NOTES:

1. PROVIDE A MINIMUM OF 3 IN. OF CLASS 2, 3/4 IN., AGGREGATE BASE BELOW VALLEY GUTTER. WHERE TOTAL PAVEMENT THICKNESS OF SIDE STREET EXCEEDS 10-1/2 IN. (MEASURED AT CENTERLINE), AGGREGATE BASE THICKNESS SHALL BE INCREASED TO MATCH TOTAL SIDE STREET PAVEMENT THICKNESS.
2. CONCRETE MIX SHALL CONSIST OF: 3/4 IN. AGGREGATE, 6 SACK, TYPE 2, PORTLAND CEMENT. PROVIDE ONE POUND LAMP BLACK PER CUBIC YARD CONCRETE.

No	By	Revision

CITY OF SAN PABLO

ONE ALVARADO SQUARE, SAN PABLO, CA 94806
(510) 215-3030 FAX 215-3031



Checked By: _____

Approved By: _____

PUBLIC WORKS DIVISION MANAGER DATE

VALLEY GUTTER DETAILS AND NOTES

NO SCALE

STD DET SD-01

SHEET 2 OF 2

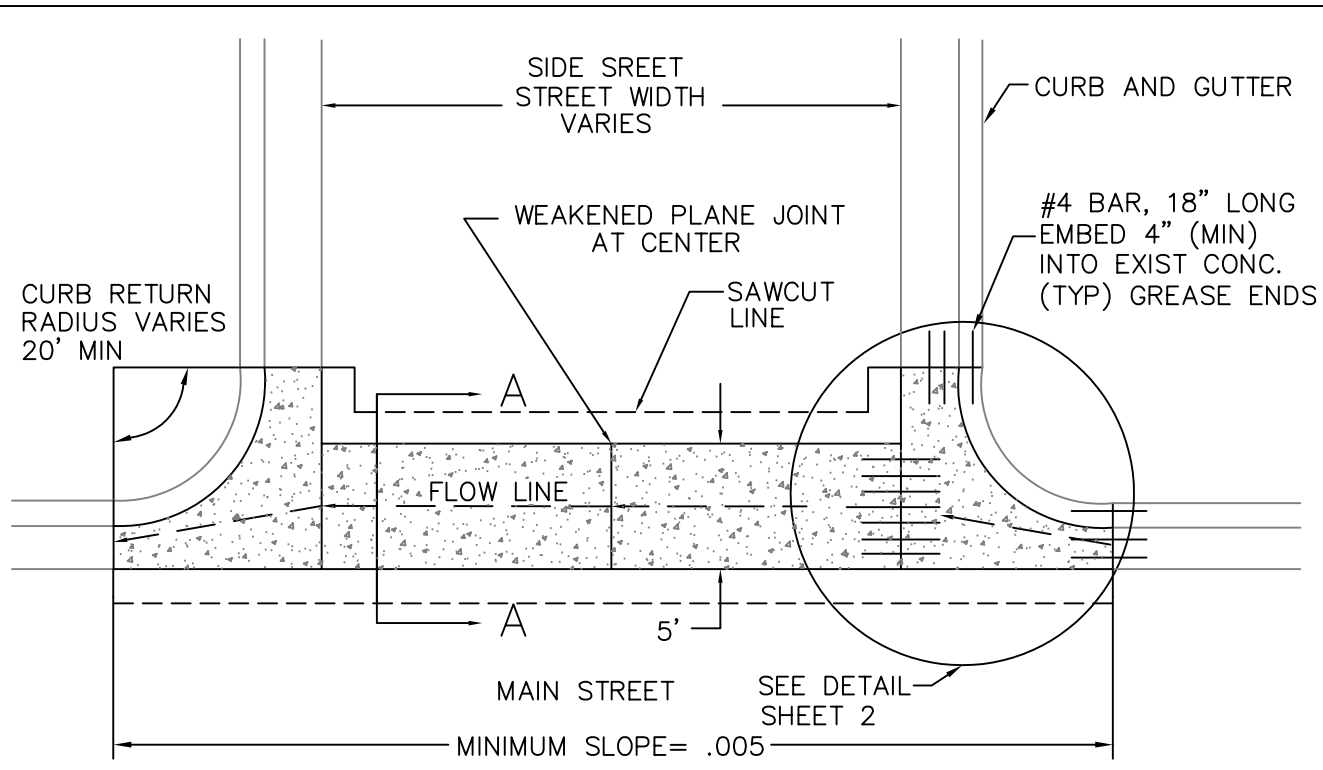

PLAN VIEW

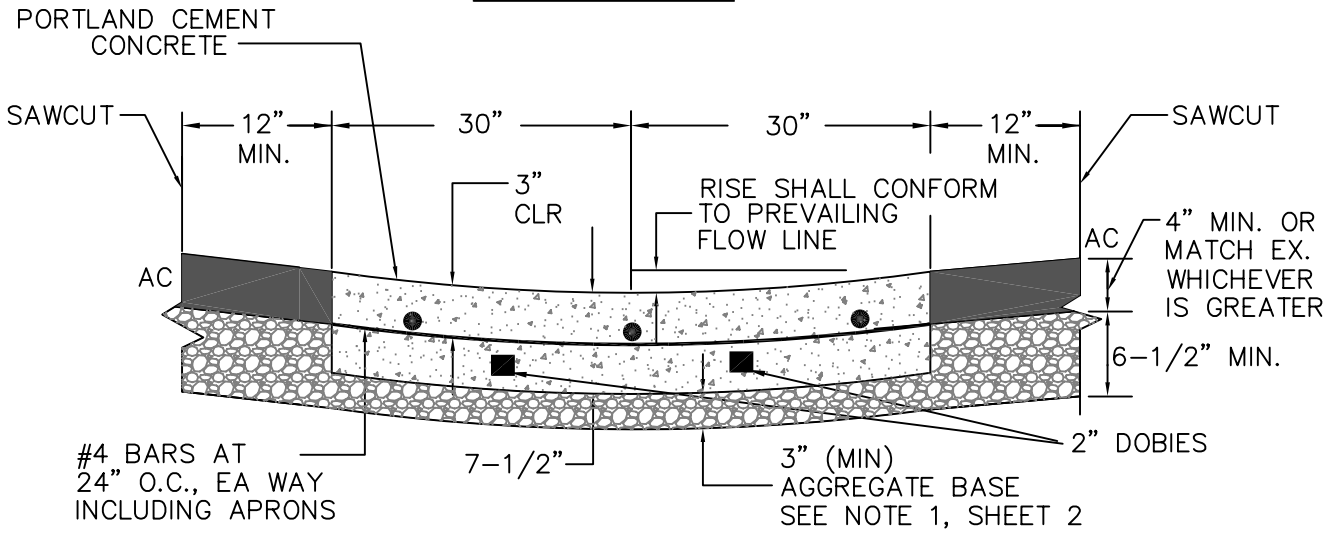

SECTION A-A

No	By	Revision

CITY OF SAN PABLO
 ONE ALVARADO SQUARE, SAN PABLO, CA 94806
 (510) 215-3030 FAX 215-3031



Checked By: _____
 Approved By: _____
 PUBLIC WORKS DIVISION MANAGER DATE

VALLEY GUTTER
 PLAN AND SECTION

NO SCALE

STD DET SD-01
 SHEET 1 OF 2