

PEAK HOUR ITM SUMMARY

#006 21st St & Pine Avenue

LOCATION#: 006	QTD PROJ#: 100158	AM PEAK: 745 AM
NORTH / SOUTH: 21st St	DATE: Tuesday, September 28, 2010	MD PEAK: 1130 AM
EAST / WEST: Pine Avenue	VICINITY: San Pablo, CA	PM PEAK: 500 PM

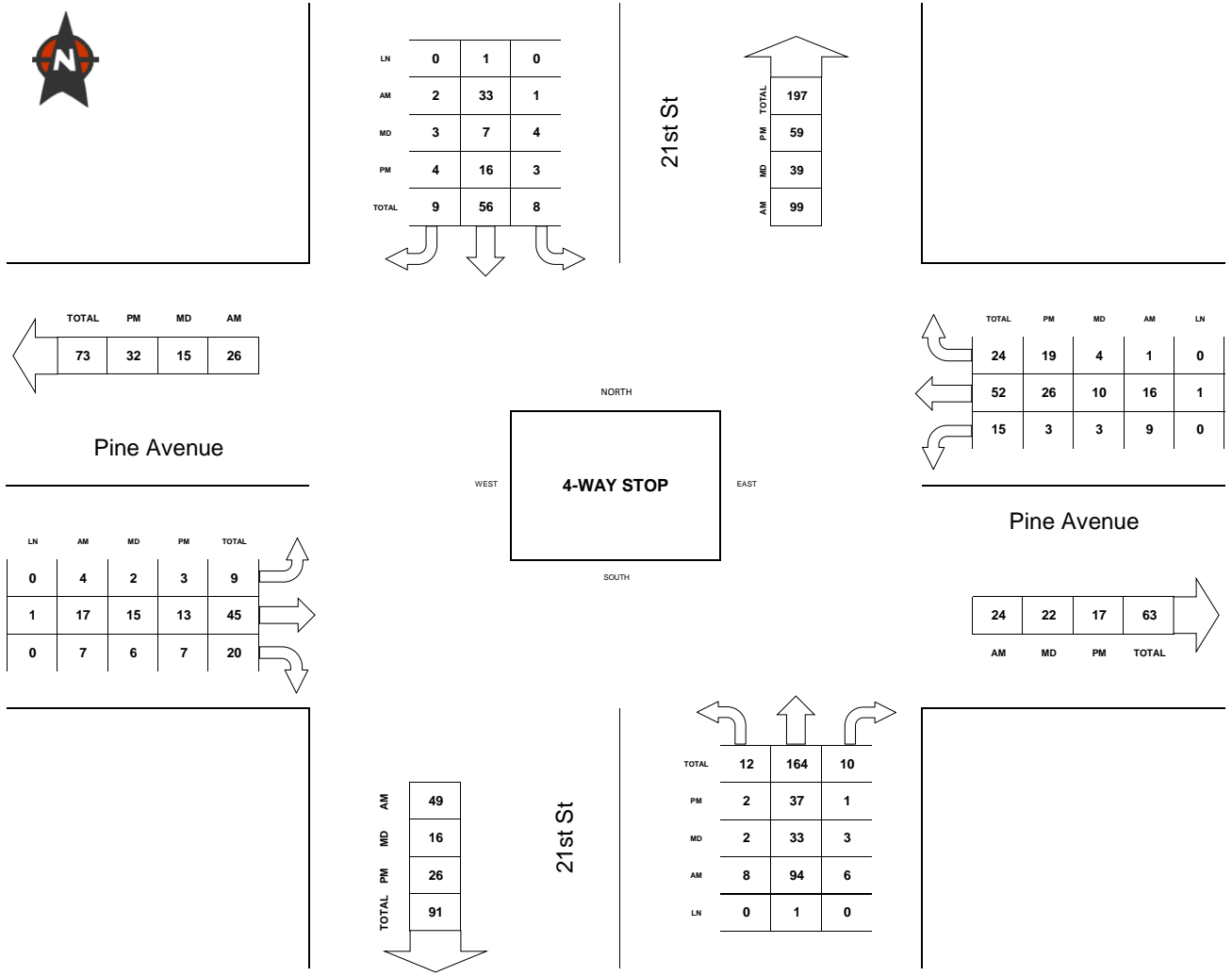

AM COUNT 7:00AM TO 9:00AM MD COUNT 11:30AM TO 1:30PM PM COUNT 4:00PM TO 6:00PM



QUALITY TRAFFIC DATA, LLC

9701 W Pico Blvd, Suite 205, Los Angeles, CA 90035
 Phone: 310-341-0019 Fax: 310-807-9247 Info@QualityTrafficData.com

VEHICLE TURNING MOVEMENT COUNT

#006 21st St & Pine Avenue - AM PEAK

LOCATION#: 006
 NORTH / SOUTH: 21st St
 EAST / WEST: Pine Avenue

QTD PROJ#: 100158
 DATE: Tuesday, September 28, 2010
 VICINITY: San Pablo, CA

DIRECTION:	NL	NT	NR	SL	ST	SR	EL	ET	ER	WL	WT	WR	TOTALS
LANES:	0	1	0	0	1	0	0	1	0	0	1	0	
6:00 AM													
6:15 AM													
6:30 AM													
6:45 AM													
7:00 AM	0	2	2	0	0	1	0	2	0	0	3	0	10
7:15 AM	0	3	0	0	2	0	0	8	1	0	1	1	16
7:30 AM	0	6	2	2	1	1	2	1	0	0	4	0	19
7:45 AM	0	18	1	1	4	0	1	3	0	0	2	0	30
8:00 AM	3	25	2	0	17	1	2	6	2	4	7	0	69
8:15 AM	2	28	1	0	8	0	1	5	3	5	4	0	57
8:30 AM	3	23	2	0	4	1	0	3	2	0	3	1	42
8:45 AM	2	11	0	0	3	0	0	5	0	0	1	0	22
9:00 AM													
9:15 AM													
9:30 AM													
9:45 AM													
10:00 AM													
10:15 AM													
10:30 AM													

VOLUME STATS:	NL	NT	NR	SL	ST	SR	EL	ET	ER	WL	WT	WR	
TOTAL:	10	116	10	3	39	4	6	33	8	9	25	2	265
P.H.V: ₁	8	94	6	1	33	2	4	17	7	9	16	1	198
P.H.F: ₂	_____	0.871	_____	_____	0.500	_____	_____	0.700	_____	_____	0.591	_____	0.717

- (1) Peak Hour Volume (Peak Hour Begins At 745 AM)
- (2) Peak Hour Factor (directional aggregate)



QUALITY TRAFFIC DATA, LLC

9701 W Pico Blvd, Suite 205, Los Angeles, CA 90035
 Phone: 310-341-0019 Fax: 310-807-9247 Info@QualityTrafficData.com

VEHICLE TURNING MOVEMENT COUNT

#006 21st St & Pine Avenue - MD PEAK

LOCATION#: 006
 NORTH / SOUTH: 21st St
 EAST / WEST: Pine Avenue

QTD PROJ#: 100158
 DATE: Tuesday, September 28, 2010
 VICINITY: San Pablo, CA

DIRECTION:	NL	NT	NR	SL	ST	SR	EL	ET	ER	WL	WT	WR	TOTALS
LANES:	0	1	0	0	1	0	0	1	0	0	1	0	
10:45 AM													
11:00 AM													
11:15 AM													
11:30 AM	2	15	2	1	3	1	0	6	1	0	5	0	36
11:45 AM	0	5	1	0	2	2	2	1	2	0	0	1	16
12:00 PM	0	6	0	2	0	0	0	3	1	2	2	2	18
12:15 PM	0	7	0	1	2	0	0	5	2	1	3	1	22
12:30 PM	0	4	1	0	3	0	2	6	1	2	2	2	23
12:45 PM	0	5	0	1	1	0	1	1	0	1	3	0	13
1:00 PM	0	2	1	0	0	1	0	4	0	0	1	0	9
1:15 PM	0	1	0	0	0	0	0	1	0	0	2	0	4
1:30 PM													
1:45 PM													
2:00 PM													
2:15 PM													
2:30 PM													
2:45 PM													
3:00 PM													
3:15 PM													
3:30 PM													
3:45 PM													

VOLUME STATS:	NL	NT	NR	SL	ST	SR	EL	ET	ER	WL	WT	WR	
TOTAL:	2	45	5	5	11	4	5	27	7	6	18	6	141
P.H.V: ₁	2	33	3	4	7	3	2	15	6	3	10	4	92
P.H.F: ₂	_____	0.500	_____	_____	0.700	_____	_____	0.821	_____	_____	0.708	_____	0.639

(1) Peak Hour Volume (Peak Hour Begins At 1130 AM)

(2) Peak Hour Factor (directional aggregate)



QUALITY TRAFFIC DATA, LLC

9701 W Pico Blvd, Suite 205, Los Angeles, CA 90035

Phone: 310-341-0019 Fax: 310-807-9247 Info@QualityTrafficData.com

VEHICLE TURNING MOVEMENT COUNT

#006 21st St & Pine Avenue - PM PEAK

LOCATION#: 006
 NORTH / SOUTH: 21st St
 EAST / WEST: Pine Avenue

QTD PROJ#: 100158
 DATE: Tuesday, September 28, 2010
 VICINITY: San Pablo, CA

DIRECTION:	NL	NT	NR	SL	ST	SR	EL	ET	ER	WL	WT	WR	TOTALS
LANES:	0	1	0	0	1	0	0	1	0	0	1	0	
3:00 PM													
3:15 PM													
3:30 PM													
3:45 PM													
4:00 PM	1	7	1	0	3	0	0	4	1	0	1	0	18
4:15 PM	2	4	0	0	2	0	1	3	0	1	7	2	22
4:30 PM	1	5	0	0	4	1	0	6	0	0	2	0	19
4:45 PM	2	7	0	0	1	0	3	5	2	0	7	4	31
5:00 PM	0	3	0	1	4	2	1	6	3	0	0	1	21
5:15 PM	2	11	0	2	3	0	2	4	1	1	9	6	41
5:30 PM	0	10	0	0	1	2	0	2	2	2	7	2	28
5:45 PM	0	13	1	0	8	0	0	1	1	0	10	10	44
6:00 PM													
6:15 PM													
6:30 PM													
6:45 PM													

VOLUME STATS:	NL	NT	NR	SL	ST	SR	EL	ET	ER	WL	WT	WR	
TOTAL:	8	60	2	3	26	5	7	31	10	4	43	25	224
P.H.V: ₁	2	37	1	3	16	4	3	13	7	3	26	19	134
P.H.F: ₂	_____	0.714 _____	_____	_____	0.719 _____	_____	_____	0.575 _____	_____	_____	0.600 _____	_____	0.761

- (1) Peak Hour Volume (Peak Hour Begins At 500 PM)
- (2) Peak Hour Factor (directional aggregate)



QUALITY TRAFFIC DATA, LLC

9701 W Pico Blvd, Suite 205, Los Angeles, CA 90035
 Phone: 310-341-0019 Fax: 310-807-9247 Info@QualityTrafficData.com